

**TREVOR CONSULTING, INC.**

P.O. BOX 1016, CANTON, GA 30115  
 PHONE: (770) 704-5375 FAX: (770) 222-4280

TRANSVERSE CLOSURE - 1/16,000+  
 ANGULAR ERROR - 2 SECONDS  
 ADJUSTMENT - COMPASS RULE  
 EQUIPMENT - TOPCON TOTAL STATION  
 PLAT CLOSURE - 1/100,000  
 MANDATED REVISIONS NOTED TO  
 MATCH REFERENCE PLAT.  
 ALL MATTERS OF TITLE EXCEPTED.

**PRELIMINARY/PROPOSED**  
 PROPOSED DEVELOPMENT  
 SHOPPER'S WORLD PLAZA  
 1180 S. WOODRIDGE  
 CUMMING, GA 30009  
 (770) 544-7000  
 S.A. CONTRACT NO.  
 S.A. 000000  
 (770) 544-7000

**GENERAL NOTES**  
 PROPERTY USE OFFICE  
 CURRENT ZONING - IS  
 TOTAL AREA - 24 ACRES (2100,000 SQ FT)  
 1. EXISTING IMPROVEMENTS - 20 ACRES (1750,000 SQ FT)  
 2. EXISTING IMPROVEMENTS - 20 ACRES (1750,000 SQ FT)  
 3. EXISTING IMPROVEMENTS - 20 ACRES (1750,000 SQ FT)  
 FROM THE TOP OF EACH CURB SHALL BE MEASURED AND SUBJECT TO ALL THE  
 COLLATERAL SURVEYING FIELD NOTES.  
 NO CONVEYANCES HAVE BEEN FOUND TO BE LOCATED ON THIS SITE.  
 IF ANY RELATED EXIST ON THIS SITE, NONE SHALL BE DEEMED WITHOUT  
 COPIES OF SURVEY APPROVALS.  
 NO ARCHITECTURAL LANDMARKS HAVE BEEN FOUND TO BE LOCATED  
 ON THIS SITE.  
 NO ARCHAEOLOGICAL LANDMARKS HAVE BEEN FOUND TO BE LOCATED  
 ON THIS SITE.  
 ALL PROPOSED DEVELOPMENT TO BE BUILT IN ACCORDANCE WITH  
 FORTYFIFTH COUNTY ZONING ORDINANCES AND REQUIREMENTS.  
 THE LAYOUT SHOWN IS A CONCEPTUAL REPRESENTATION OF THE  
 PROPOSED DEVELOPMENT FOR THIS SITE. SPECIAL REVIEW ORDERS IN  
 ACCORDANCE WITH THE ZONING ORDINANCES SHALL BE OBTAINED FROM THE  
 FORTYFIFTH COUNTY ZONING BOARD AND APPROVAL PROCEDURE.  
 STREET LIGHTS WILL BE UNDERGROUND THROUGHOUT THE PROPERTY.  
 SIGNAGE AND SIGNPOSTING SHALL BE SUPPLIED BY DEVELOPER.

**GENERAL NOTES**  
 THE PROPERTY IS NOT LOCATED WITHIN  
 A 100 YEAR FLOOD FLOOD ZONE ACCORDING TO  
 FORTYFIFTH COUNTY PLANNING PANEL, CODE C,  
 COMMUNITY #130012 DATED: JULY 4, 1999.

**PERMITS AND LICENSES NOTES**  
 FOR ALL WORKING SHALL OBTAIN A PERMITS OR LICENSES NECESSARY TO OBTAIN  
 AND MAINTAIN ALL NECESSARY PERMITS OR LICENSES OF THE COURSE  
 OF LABORING.  
 ALL WORKING SHALL BE IN ACCORDANCE WITH ALL CITY AND STATE  
 ORDINANCES, REGULATIONS AND CODES APPLICABLE TO THE WORKING  
 TO BE DONE ON THIS PROJECT.  
 ALL PERMITS AND LICENSES SHALL BE OBTAINED ON THE DATE SET AS  
 THE DATE OF THE WORKING.  
 THE PERMITS AND LICENSES SHALL BE OBTAINED ON THE DATE SET AS  
 THE DATE OF THE WORKING.  
 THE PERMITS AND LICENSES SHALL BE OBTAINED ON THE DATE SET AS  
 THE DATE OF THE WORKING.  
 THE PERMITS AND LICENSES SHALL BE OBTAINED ON THE DATE SET AS  
 THE DATE OF THE WORKING.

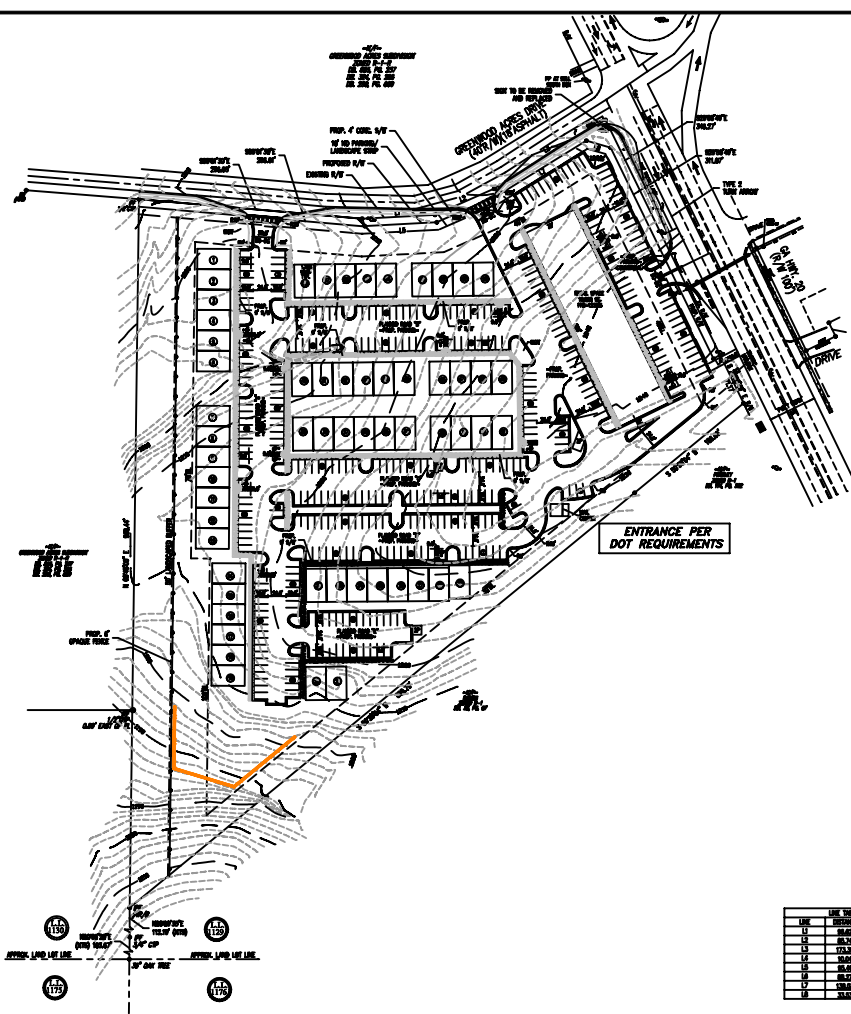

**GENERAL NOTES**  
 THE PROPERTY IS NOT LOCATED WITHIN  
 A 100 YEAR FLOOD FLOOD ZONE ACCORDING TO  
 FORTYFIFTH COUNTY PLANNING PANEL, CODE C,  
 COMMUNITY #130012 DATED: JULY 4, 1999.

**PERMITS AND LICENSES NOTES**  
 FOR ALL WORKING SHALL OBTAIN A PERMITS OR LICENSES NECESSARY TO OBTAIN  
 AND MAINTAIN ALL NECESSARY PERMITS OR LICENSES OF THE COURSE  
 OF LABORING.  
 ALL WORKING SHALL BE IN ACCORDANCE WITH ALL CITY AND STATE  
 ORDINANCES, REGULATIONS AND CODES APPLICABLE TO THE WORKING  
 TO BE DONE ON THIS PROJECT.  
 ALL PERMITS AND LICENSES SHALL BE OBTAINED ON THE DATE SET AS  
 THE DATE OF THE WORKING.  
 THE PERMITS AND LICENSES SHALL BE OBTAINED ON THE DATE SET AS  
 THE DATE OF THE WORKING.  
 THE PERMITS AND LICENSES SHALL BE OBTAINED ON THE DATE SET AS  
 THE DATE OF THE WORKING.

**SITE PLAN OF:  
 SHOPPER'S WORLD CUMMING**

**LOCATION MAP SCALE - 1"=2000'**

PROPERTY IS LOCATED IN LAND LOT 1180  
 OF THE 1000 PARCELS, 1ST SECTION  
 FORTYFIFTH COUNTY, GEORGIA

**GRAPHIC SCALE**  
 ( IN FEET )  
 1 inch = 60 ft.

DATE	BY	REVISION DESCRIPTION
7/11/07	FLP	7/11/07
	KT	
	100601337E	9

LINE	DESCRIPTION	REVISION
1	...	...
2	...	...
3	...	...
4	...	...
5	...	...
6	...	...
7	...	...
8	...	...
9	...	...
10	...	...